

Sports Camp Guide **TOTTORI** TO TOKYO 2020

Tottori Prefecture Tokyo Olympic and
Paralympic Camp Promotion Committee

1-220 Higashi-machi Tottori-city Tottori Prefecture 680-8570 JAPAN

TEL +81-857-26-7921 FAX +81-857-26-8108

✉ sports-tottori@pref.tottori.jp



Optimal training conditions amidst the abundant nature and quiet environment of Tottori Prefecture.

Tottori Prefecture is located in western Japan. It is a compact region spanning about 120km east to west and 20 to 50km north to south. Tottori is the least populated prefecture in Japan.

Area: 3,507km²
 Population: Approx. 570,000 people
 Municipalities: 4 Cities, 14 Towns and 1 Village



Abundant Nature

Tottori Prefecture is blessed with a rich natural environment. The region faces the Sea of Japan to the north and features a continuous white sand and green pine coastline which includes the Tottori Sand Dunes. A mountain range that includes Mt. Daisen - the highest peak in the Chugoku Region - stretches along the southern part of the prefecture. Tottori is also home to two national parks: the San'in Coast, which has been designated as a Global Geopark, and Nakaumi, a registered Ramsar site.

We look forward to your stay.

Tottori Prefecture is surrounded by abundant nature which gives birth to a wealth of foods. Our prefecture offers many accommodations and sports facilities. We are also blessed with a relatively mild climate.

Our high quality sports facilities include the Fuse Sports Park where the Jamaican track and field team held their training camp in preparation for the World Championships.

Moreover, this region is also dotted with natural and cultural tourism resources. These include the Sanin Coast National Park that has been certified as a Global Geopark and the Tottori Sand Dunes, as well as Daisen National Park and the national treasure of Nageiredo on Mt. Mitoku. We have great potential as a sports

resort.

We are aiming to attract teams to set up camp in Tottori for the 2020 Tokyo Olympic and Paralympic Games.

Our dream is to have Tottori Prefecture become a sports resort where people from all over the world visit to exercise their bodies, enjoy nature and culture, and engage in exchange with a diverse range of people.

The administration, sports organizations, and local people in Tottori are committed to providing integrated support and warm hospitality. Please visit Tottori Prefecture!



Shinji Hirai,
 Chairman of the Tottori Prefecture Tokyo Olympic and Paralympic Camp Promotion Committee
 Governor of Tottori Prefecture

A Quiet Environment

Tottori Prefecture is surrounded by a transparent blue sea and lush green mountains. It is the least populated prefecture in Japan. We have a quiet environment where athletes can focus on training without the stress of traffic congestion or overpopulation found in urban areas.

Camp and Tournament Promotion Initiatives

Tottori is actively encouraging teams to hold camps in our prefecture in order to promote regional development through sports. The Tottori Prefecture Tokyo Olympic and Paralympic Camp Promotion Committee was established in May 2015 to attract camps to Tottori in cooperation with municipalities and sports organizations. Tottori has already gained a strong reputation as a training camp for high school and university students from outside the prefecture, as well as top national and international teams. Moreover, Tottori Prefecture has hosted a wide variety of national sports tournaments.

- 2002: Ecuador Team Camp for the Japan-Korea World Cup (Tottori Bird Stadium)
- 2004: Athens Olympic Games Qualifying Competition and Japan Athletics Championships (Fuse Sports Park)
- 2006: Japan Cycling Championships (Kurayoshi Cycling Track)
- 2007: Jamaican Track and Field Team Training Camp for the World Athletics Championships in Osaka (Fuse Sports Park)
- 2010: All Japan Junior High School Athletics Championships (Fuse Sports Park)
- 2012: London Paralympic Games Japan Association of Athletics Federations for the Disabled Training Camp (Fuse Sports Park)
- 2013: Sofia Deaflympics Games Japanese Track and Field Athlete Training Camp (Fuse Sports Park)
- 2014: All Japan Laser Class Championships (Sakaiminato Public Marina)
- 2015: Jamaican Track and Field Team Training Camp for the World Athletics Championships in Beijing (Fuse Sports Park)
- 2015: Japan Table Tennis Hopes Team Training Camp (Fuse Sports Park)
 (Held outside Tokyo for the first time since the completion of the National Training Center)
- 2015: All Japan 470 Class Yacht Championships (Sakaiminato Public Marina)
- 2016: Fuse Sports Park and Athletics Stadium wheelchair accessibility upgrades
- 2016: Japan Para Athletics Championships (Fuse Sports Park)
- 2016: Japan Table Tennis Hopes Team Training Camp (Fuse Sports Park)

Reasons that make suitable place

Compact Region

Convenient Access to Tokyo ; Airport, Sports Facilities, and Accommodations Located in Close Proximity

Travel from Tottori and Yonago to Haneda by airplane takes about 1 hour and 20 minutes. Yonago Airport also offers regular flight service to Incheon Airport in Korea. The airports, sports facilities, and accommodations are located in close proximity within a compact region. Travel between the various sites and facilities is quick and convenient as there is no traffic congestion.

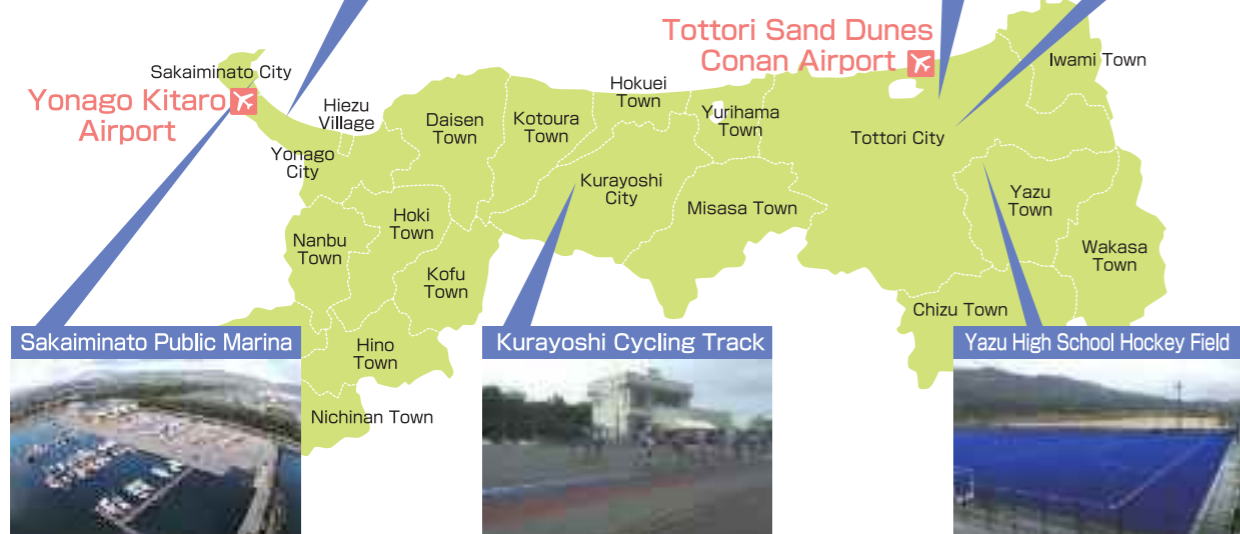
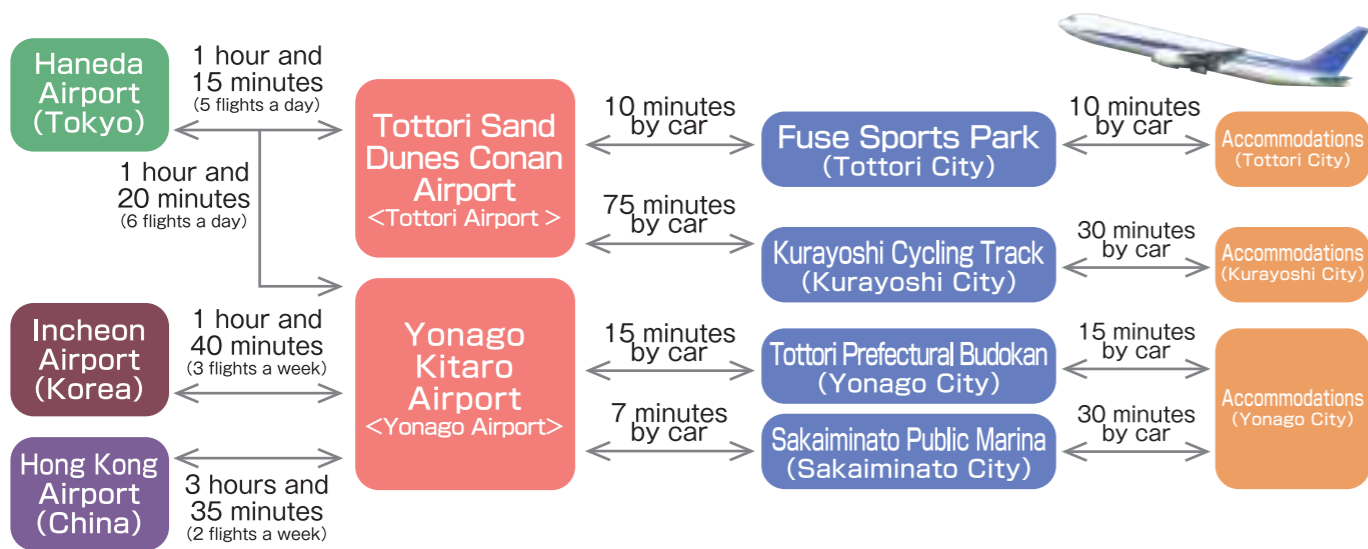

Tottori Prefecture a for a sports camp.

Tottori's training environment is unique to the region.

Abundant Foods

A Wide Variety of Flavors and Ingredients Fostered by Mother Nature

Tottori Prefecture is blessed with an abundance nature consisting of the sea, mountains, and surrounding villages. This rich environment produces plenty of fresh, seasonal foods. Delicious foods are part of daily life in Tottori. The sea, mountains, and villages make Tottori Prefecture a treasure trove of delicacies.



Warm Hospitality

Support from Friendly Residents

The participation rate for volunteer activities in Tottori Prefecture is the highest in Japan. The prefecture is advancing an initiative entitled "Ai Support" which aims to realize a symbiotic society with the catchphrase "living together with awareness of disabilities."



During a winter storm that prevented cars from moving for two days, local residents were eager to help clear away snow and provide food. The sports camps in Tottori Prefecture are supported by the warm hospitality of friendly residents.

Soothing Hot Springs

Relax your Body and Mind

Hot springs have been boiling in Tottori Prefecture since ancient times. The local culture still enjoys hot springs as a part of everyday life. Both the famous springs as well as secluded baths offer comfort and relaxation to tired bodies in need of rejuvenation. There are a wide variety of hot springs featuring unique characteristics such as ancient history, views of natural landscapes, and springs of longevity which boil from the sea.

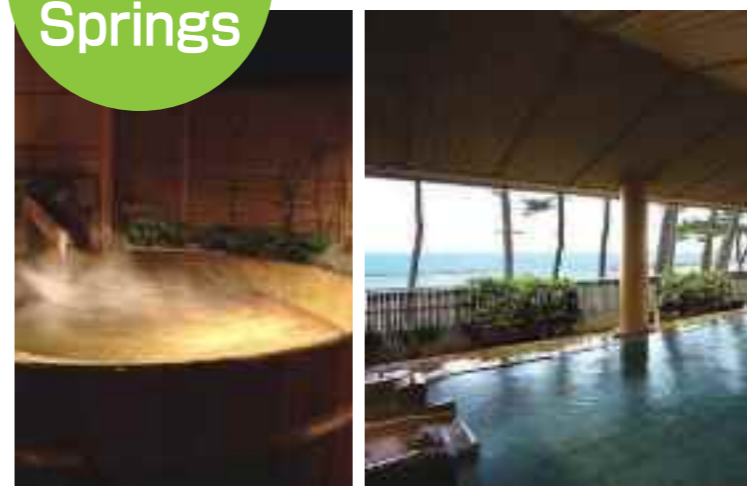

Delicious Water



A Nutritional Source of Life that is the Pride of Tottori Prefecture

Tottori Prefecture is famous for its water. The prefecture is blessed with lush greenery, such as the largest beech forest in western Japan located at the foothills of Mt. Daisen. Rain and snow which accumulates in the mountains turns into underground water. After passing through the earth's natural filters, delicious soft water with a balance of minerals (e.g. sodium and calcium) and carbonic acid springs forth at various places in the prefecture. Leading beverage companies use the water from Tottori Prefecture for their products.



Comfortable Climate

Excellent Environment for Sports Training

The climate in Tottori Prefecture is relatively mild, with good weather from spring to autumn. The hours of sunlight in Tottori between April and August are longer than in Tokyo. Tottori offers a perfect environment for sports, with warm temperatures during the day suitable for exercise, and cool temperatures at night which provide comfortable conditions for resting and preserving physical strength.

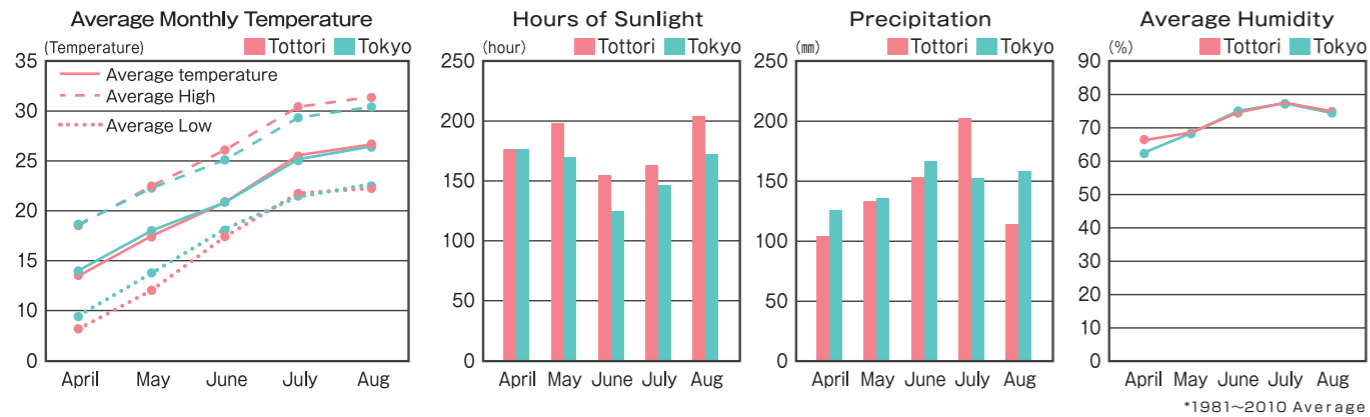

Medical Treatment

Safe Emergency Medical Treatment

Hospitals and emergency medical centers are located near the sports facilities allowing for prompt treatment in the event of an emergency. Athletes can train with peace of mind as doctors with proper medical equipment and devices are available to provide an immediate response to injuries. There is even a medical helicopter available which offers quick access to emergency sites.

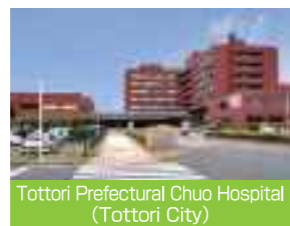

Accommodations

There are many diverse accommodations around the sports facilities ranging from urban hotels to hot spring ryokans (Japanese-style inns). The accommodations in Tottori support visiting athletes with warm hospitality.



Accommodations Facilities in Eastern Tottori Prefecture

Tottori city area	Number of Facilities	Capacity
H o t e l	16	about 2,180
R y o k a n	7	about 340
Y o s h i o k a O n s e n	13	about 390
S h i k a n o O n s e n	2	about 130
I w a i O n s e n	3	about 210
T o t a l	41	about 3,250

Eastern Region	Number of Facilities	Capacity
H o t e l	16	about 2,180
O n s e n	22	about 1,090
R y o k a n	18	about 550
O t h e r	55	about 2,660
T o t a l	111	about 6,480

Accommodation Facilities in Central Tottori Prefecture

Kurayoshi city area	Number of Facilities	Capacity
H o t e l	14	about 560
R y o k a n	9	about 240
T o g o O n s e n	7	about 620
H a w a i O n s e n	15	about 1,600
M i s a s a O n s e n	25	about 3,240
S e k i g a n e O n s e n	4	about 310
T o t a l	74	about 6,570

Central Region	Number of Facilities	Capacity
H o t e l	18	about 670
O n s e n	48	about 5,310
R y o k a n	12	about 300
O t h e r	8	about 1,050
T o t a l	86	about 7,330

Accommodation Facilities in Western Tottori Prefecture

In Yonago City	Number of Facilities	Capacity
H o t e l	28	about 3,160
R y o k a n	11	about 300
K a i k e O n s e n	20	about 3,860
T o t a l	59	about 7,320

Western Region	Number of Facilities	Capacity
H o t e l	36	about 4,190
O n s e n	26	about 4,470
R y o k a n	52	about 2,430
O t h e r	66	about 2,370
T o t a l	180	about 13,460

*Current as of May 2014

Eastern Tottori

This area features a picturesque landscape which interweaves nature sites such as the Tottori Sand Dunes and Uradome Coast. The prefectural capital Tottori City is located in the center of this region and serves as the base for many businesses and commercial facilities. Tottori City is a historical castle town with numerous designated cultural assets. A diverse range of hot springs can be enjoyed in this region.



Tottori Prefectural Fuse Sports Park

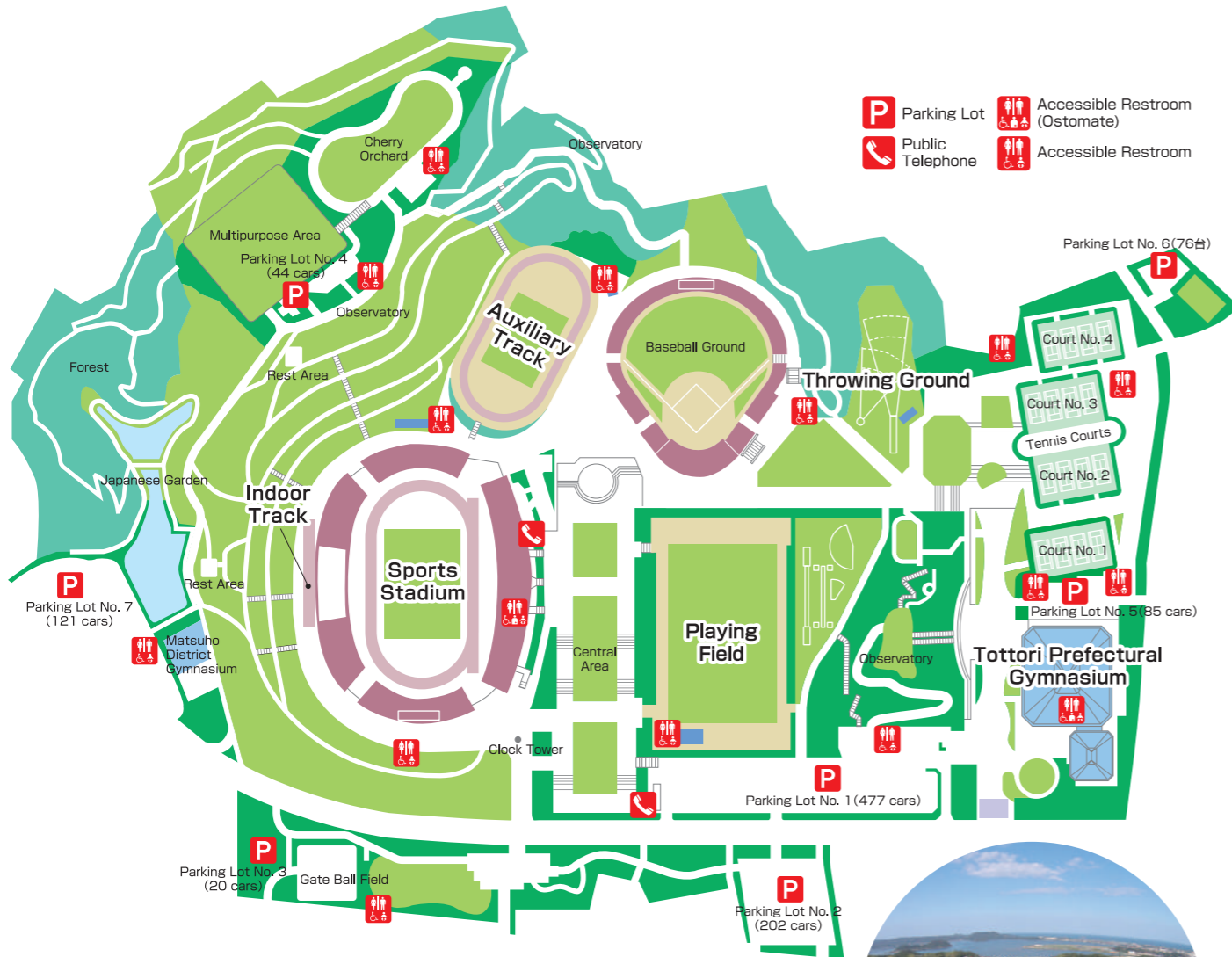

- P** Parking Lot
- ☎** Public Telephone
- ♿** Accessible Restroom (Ostomate)
- ♿** Accessible Restroom



Fuse Sports Park hosted a training camp for the Jamaican track and field team in preparation for the World Athletics Championships in 2007 and 2015.

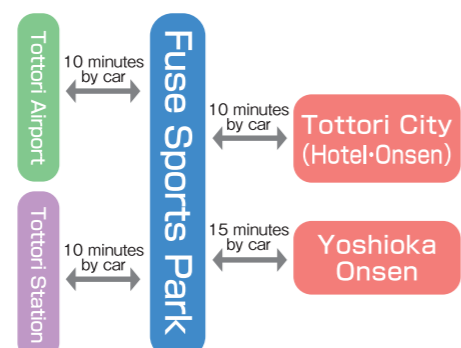
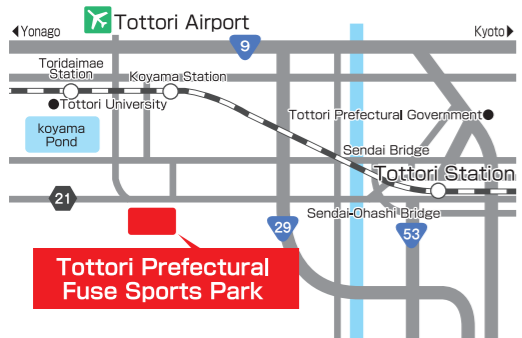

〒680-0944
146-1 Fuse
Tottori City Tottori Prefecture

<http://www.fuse-sportspark.com/service/access.html>

Sports Stadium



- International Association of Athletics Federations CLASS-2 Certified Stadium
- Japan Association of Athletics Federations Class 1 Certified Stadium
- All-Weather Synthetic Rubber Track (Super X) 400m × 9 Lanes
- 4 Night Lights / Large Video Equipment



Training Room



Auxiliary Track

- Japan Association of Athletics Federations Class 3 Certified Stadium
- All-Weather Synthetic Rubber Surface (Super X)
- 400m × 6 Lanes / 100m × 10 Lanes

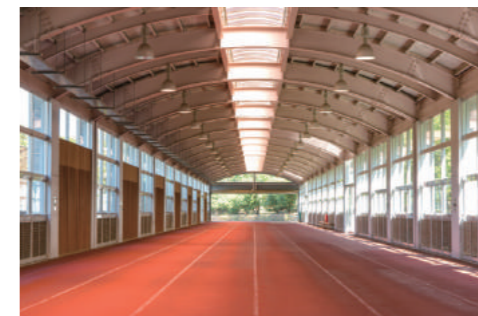

Indoor Track

- All-Weather Synthetic Rubber Track (Super X) 100m × 4 Lanes
- Long Jump and Triple Jump



Throwing Ground

- Javelin, Hammer, Discus, etc. (Approx. 7,000 m²)

Playing Field



- 154m × 84m Natural Grass Field
- Club House



Tottori Prefectural Gymnasium



Main Area (2,450m²)

- 30 Table Tennis Courts, 3 Basketball Courts, 4 Volleyball Courts
- Fully Air-Conditioned, Additional Facilities such as Meeting Rooms, Training Rooms, etc.
- Sports Equipment in line with International Standards



S p o r t	Main Arena Courts	Sub-Arena Courts	Area Dimensions(m)
T a b l e t e n n i s	30	10	36×60
B a s k e t b a l l	3	1	32×57
T e n n i s	4	—	35.57×64
V o l l e y b a l l	4	2	35×52
H a n d b a l l	1	—	24×26
B a d m i n t o n (D o u b l e s)	14	4	30.3×64
B a d m i n t o n (S i n g l e s)	14	4	35.72×64

Sub-Arena (850m²)

- 10 Table Tennis Courts, 1 Basketball Courts, 2 volleyball Courts



Training Room

- Various Training Equipment, Fitness Machines



Locker Room

- Showers



Training Room

Tottori Bird Stadium



- J-League Approved Soccer Stadium (Home Stadium for Gainare Tottori)
- 29,410m² Main Ground
- Locker Rooms, Medical Office, etc.
- Hosted 2002 Japan-Korea World Cup Ecuador Team Camp



Locker Room



Medical Office

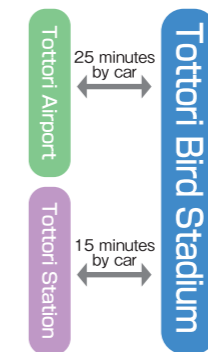

15 minutes by car
Tottori City (Hotel-Onsen)

25 minutes by car
Yoshioka Onsen

〒680-1141
423 Kurata
Tottori City Tottori Prefecture

<http://www.tottori-bird.com/index.html>



Yazu High School Hockey Field



- Olympic standard polyethylene water-based artificial lawn certified by the International Hockey Federation

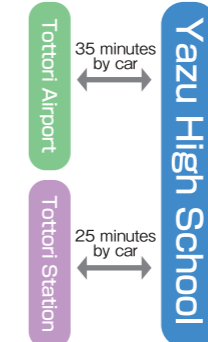
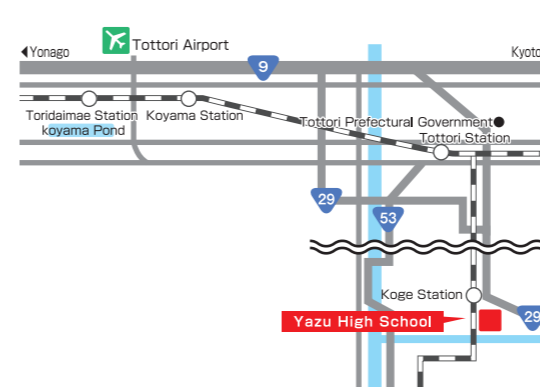

25 minutes by car
Tottori City (Hotel-Onsen)

35 minutes by car
Yoshioka Onsen

〒680-0492
725 Kunouji Yazu-cho
Yazu-gun Tottori Prefecture

<http://www.hockey.or.jp/field/chugoku/tottori/hachigashira/>



Central Tottori

Kurayoshi City, located in the central part of the prefecture, is a region with a nostalgic atmosphere. Many traditional homes and buildings can be found in areas such as the Utsubuki Tamagawa District, which has been nationally designated as an Important Traditional Architecture Preservation District. In addition, multiple hot spring resorts, as well as the most dangerous national treasure and ascetic training ground Mt. Mitoku Sanbutsuji Nageiredo, are located just outside the city.



Kurayoshi Cycling Track



- Certified by Japan Cycling Federation
- 333m Cycle Track
- Changing Rooms, Showers, Medical Office, Meeting Rooms, etc.
- Wheelchair Accessibility
- Dernys Available for Pacing

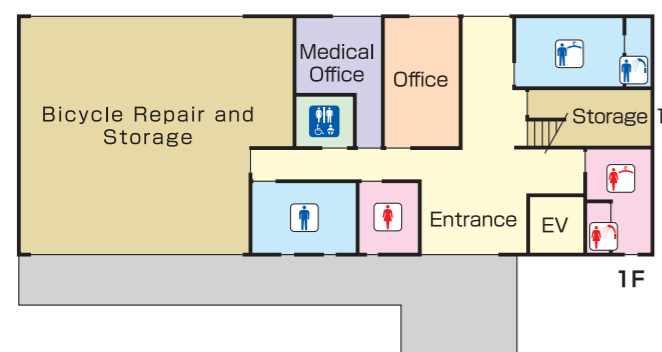
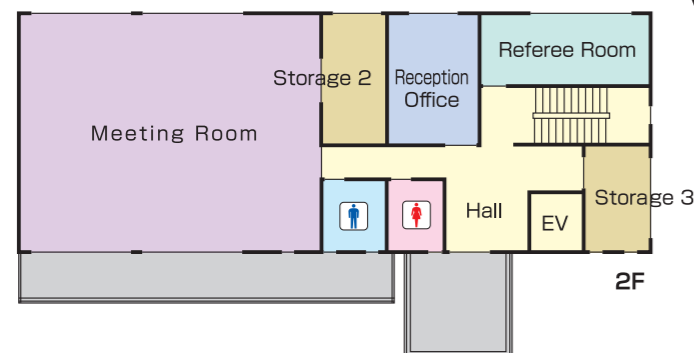
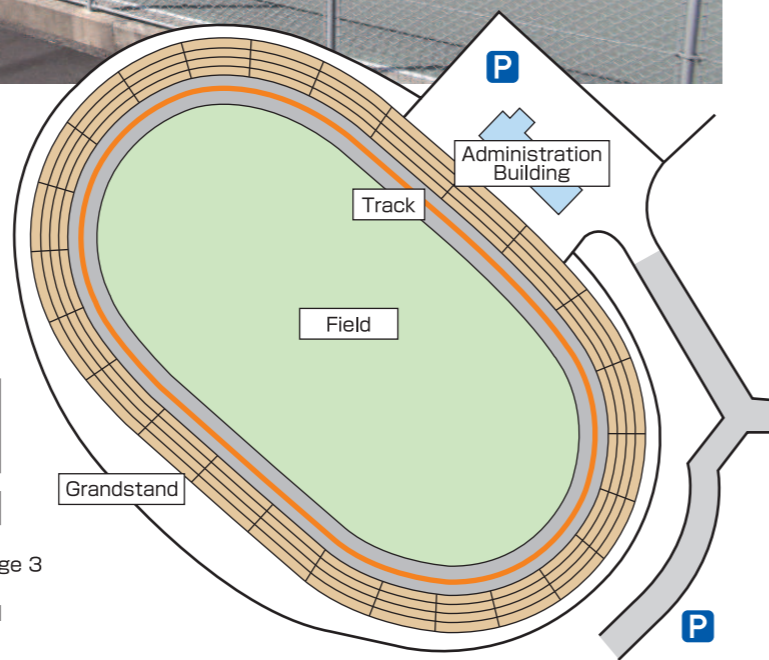

Detail		Dimensions
Circumferential Length		333.333m
Design Speed		14.5m / sec
Major Axis Length		128.385m
Minor Axis Length		71.131m
Track Width	Home	9.000m
	Back	9.000m
	Center	7.500m
Evacuation Passageway Width		2,000m Quintic Curve
Surface	Straight Length	7'~00'~00"
	Inclination	Center 33'~00'~8"
Transition Curve Type		McConnell Curve
Smallest Curvature Radius		33.000m
1/4 Circumference Length	Straight Length	10.310m
	Transition Curve Length	51.000m
	Circumference Curve Length	22.023m

Road Race Course

- Located near Kurayoshi Cycling Track
- Lap Distance: 11.6km Maximum Elevation Difference: 192m Average Slope: 4.9%

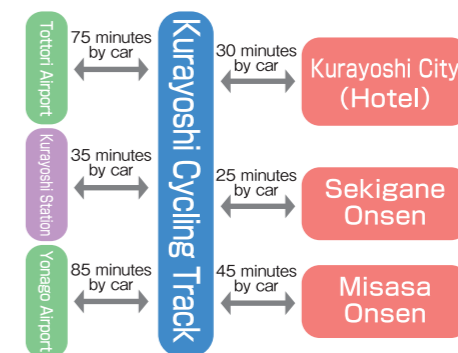

〒682-0634
68-24 Sakura-aza Ushiroyama
Kurayoshi City Tottori Prefecture



Kurayoshi Sports and Cultural Hall



- Central Tottori Base for Sports and Culture
- 3 Tennis Courts, 3 Volleyball Courts, 10 Badminton Courts, 30 Table Tennis Tables, 1 Handball Court
- Fully Air-Conditioned
- Changing Rooms, Showers, Medical Office, Meeting Rooms, etc.

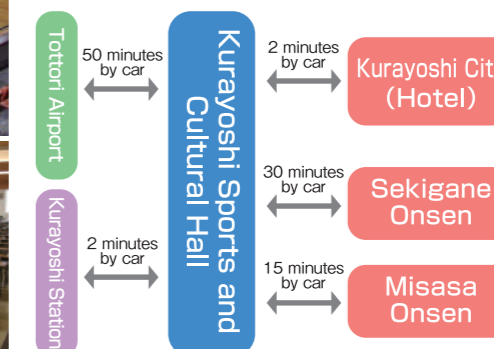

〒682-0023
529-2 Yamane
Kurayoshi City Tottori Prefecture

Western Tottori

The western part of Tottori Prefecture is centered around Yonago City, the commercial center of the San'in region, and Sakaiminato City, which boasts the leading catch of fish in Japan. The area is known as the Gateway to San'in as it is a key point for expressways, railways and air and sea routes. This is a region with abundant nature such as the Daisen National Park, the majestic Sea of Japan, and the Ramsar wetland Nakaumi.



Sakaiminato Public Marina



Administration Building



Boathouse

- Certified JOC Sailing Competition Training Center
- Favorable Wind Conditions
- 400 Ship Capacity Yacht Harbor

- [Boathouse]
- 11m Boat Measuring Space
 - Allows Fitting with Mast
 - 8m Shutter Allows Porting with Mast

Mooring Facilities	<ul style="list-style-type: none"> ● Pier 1: 17 Boats ● Pier 2: 22 Boats ● Pier 3: 22 Boats *Visitor Berths Available
Boatyard	Cruiser Yachts, Powerboats: 79 Dinghies: 210
Raising and Lowering Equipment	Winch: 8t × 1 Crane: 2.8t × 1 Ramp W: 20 × 2
Administration Building (Club House)	1F: Reception, Lobby, Boathouse, Locker Rooms, Shower 2F: Training Rooms, Dining Room, Kitchen 3F: Observation Room, Machine Room
Boathouse	Boat Storage, Boat Measuring Space, Office, Meeting Space, Tournament Equipment Storage, Restrooms, Training Space

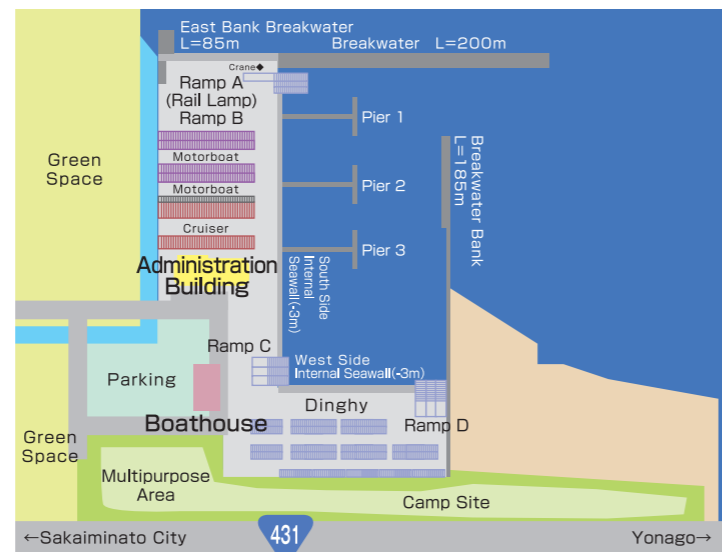

7 minutes by car to Yonago Airport
 12 minutes by car to Sakaiminato City (Hotel)
 30 minutes by car to Yonago City (Hotel)
 30 minutes by car to Yonago Station
 25 minutes by car to Kaike Onsen

☎684-0051
 3458 Niya cho
 Sakaiminato City Tottori Prefecture
<http://www.sakaiminato-marina.server-shared.com>

Tottori Prefectural Budokan



Main Dojo: 1,634 m² Floor Area 660 Tatami (Regular: 6 / National Tournament: 4)

- National Level Facilities
- Flooring, Sound/Lighting Equipment for Martial Arts
- Fully Air-Conditioned



Small Dojo1



Small Dojo2

Small Dojo : 540 m² Floor Area 288 Tatami (Regular: 2 /National Tournament: 1)

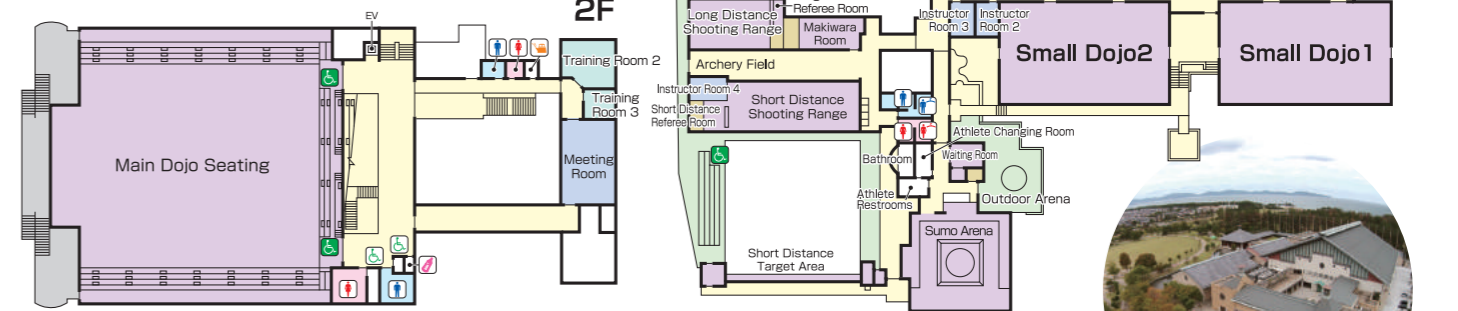

Other: Meeting Room (1), Training Room (3), Changing Room, Shower, etc.

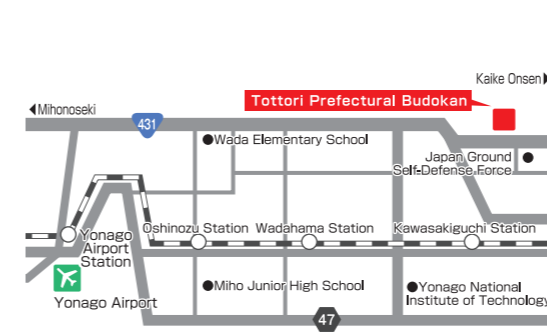

15 minutes by car to Yonago Airport
 15 minutes by car to Yonago City (Hotel)
 10 minutes by car to Kaike Onsen

☎683-0853
 3192-14 Ryomitsuyanagi
 Yonago City Tottori Prefecture
<http://www.budoukan.jp>

